

Aberdeen
Community Development District

475 West Town Place

Suite 114

St. Augustine, Florida 32092

District Website: www.AberdeenCDD.com

February 14, 2022

Board of Supervisors
Aberdeen Community Development District

Dear Board Members:

The Aberdeen Community Development District Workshop is scheduled for **Wednesday, February 16, 2022 at 6:30 p.m.** at the Aberdeen Amenity Center, 110 Flower of Scotland Avenue, St. Johns, Florida 32259.

Following is the advance agenda for the meeting:

- I. Roll Call
- II. Public Comments (*regarding agenda items below*)
- III. Discussion Regarding Common Area Greenspace
- IV. Supervisor's Request and Public Comments
- V. Next Scheduled Meeting – 02/22/22 @ 4:00 p.m.@ Aberdeen Amenity Center
- VI. Adjournment



GREEN SPACE

Workshop

February 16th, 2022

7 Green Spaces Identified

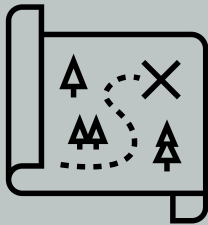

Aberdeen CDD – Irish Tartan Way

Aberdeen CDD – Prince Albert Avenue

Aberdeen CDD – Fort William Drive

Aberdeen CDD – Sterling Bridge

Aberdeen CDD – Braewick

Aberdeen CDD – Sutherland Forest

Aberdeen CDD – River Dee

719 OR 723 Irish Tartan Way By Pam Moore



30.091811, -81.607705

200.00 ft

100.00 ft

Irish
Tartan Way

720

716

712

708

704

700

728

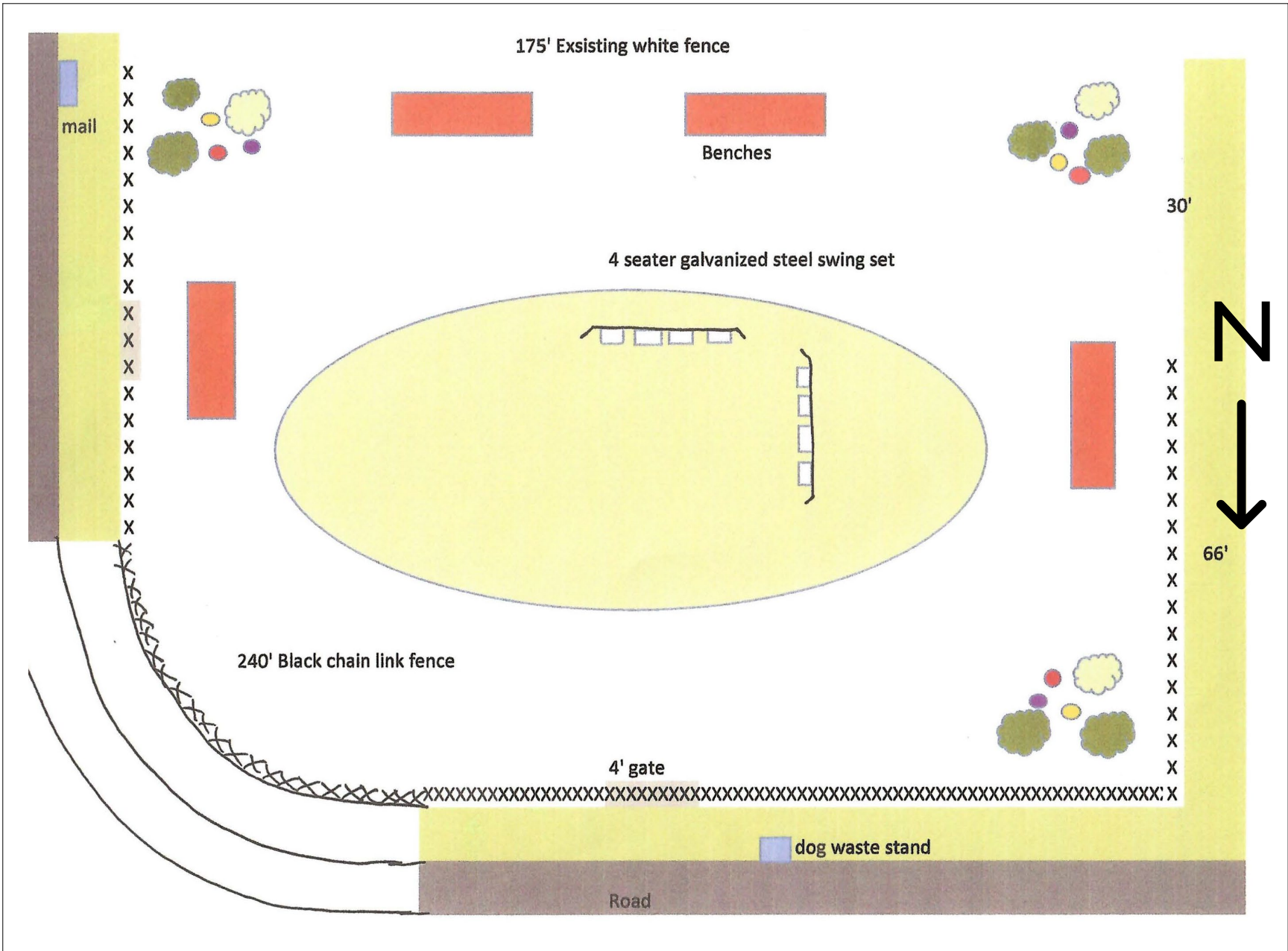

SEATON MANOR PARK PROPOSAL BY PAM MOORE

o 719 or 723, St.
Johns, FL 32259

Survey and Type Of Playgrounds

- **This is to get us started** with a play area for the residents of the Aberdeen Community.
- The children need a safe area so that they're not worried about their balls going into the street.
- This area can initially be used for practicing: baseball, soccer, football, baseball & softball.
- According to a survey taken in April 2021, out of the 156 resident homes in Seaton Manor 126 gave their opinion.
- **The consensus is 121 are for a playground, only 5 are against.**
- When the petition was taken, there was an option for putting in a fence with an oval shape cement sidewalk for roller blading.
- **The majority don't care which kind of park to put in, they just want a park.**

The results for different types of playgrounds are:

- 95 are for ages 2-5**
- 103 are for ages 3-7**
- 91 are for a fence**
- 78 are for a dog run**

Submitted by
Pam Moore



Equipment



- If at sometime in the future there are funds, then we can consider putting in playground equipment geared for ages 3-7.
- **To get us started:**
- *140' long black chain link fence that is 4' high with 2 gates.
- * 4 blue plastic coated steel benches
- * Two 4 seater galvanized swing sets with blue seats
- * 9 crepe myrtle trees, 3 for 3 corners

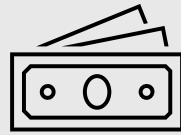

Pricing

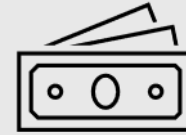

Submitted by
Pam Moore

	Price	#	Subtotal	Shipping	Installation	Total	Seller
Swing Set	\$2,321	2	\$4,642			\$4,642	Byoplayground.com
Four Benches	\$468	4	\$1,872			\$1,872	Thebenchfactory.com
Fence 240' =	\$5,700	1	\$5,700			\$5,700	Homeadvisor.com
Trees – 15 Gallon	\$80	9	\$720	\$45	\$225	\$990	S&J Tree Farm
Mulch	\$25	9	\$225			\$225	
Total Cost						\$13,204	

IRISH TARTAN
→ FORT WILLIAM

HOMEOWNERS OF GRANDHOLM POINT ESTATES

JUNE 29, 2021

PRINCE ALBERT AVENUE

↑
N



PRINCE ALBERT AVENUE PROPOSAL

Prepared by: Derrick Sims & Patricia
Russell

Prince Albert Avenue

Prepared by: Derrick Sims & Patricia Russell

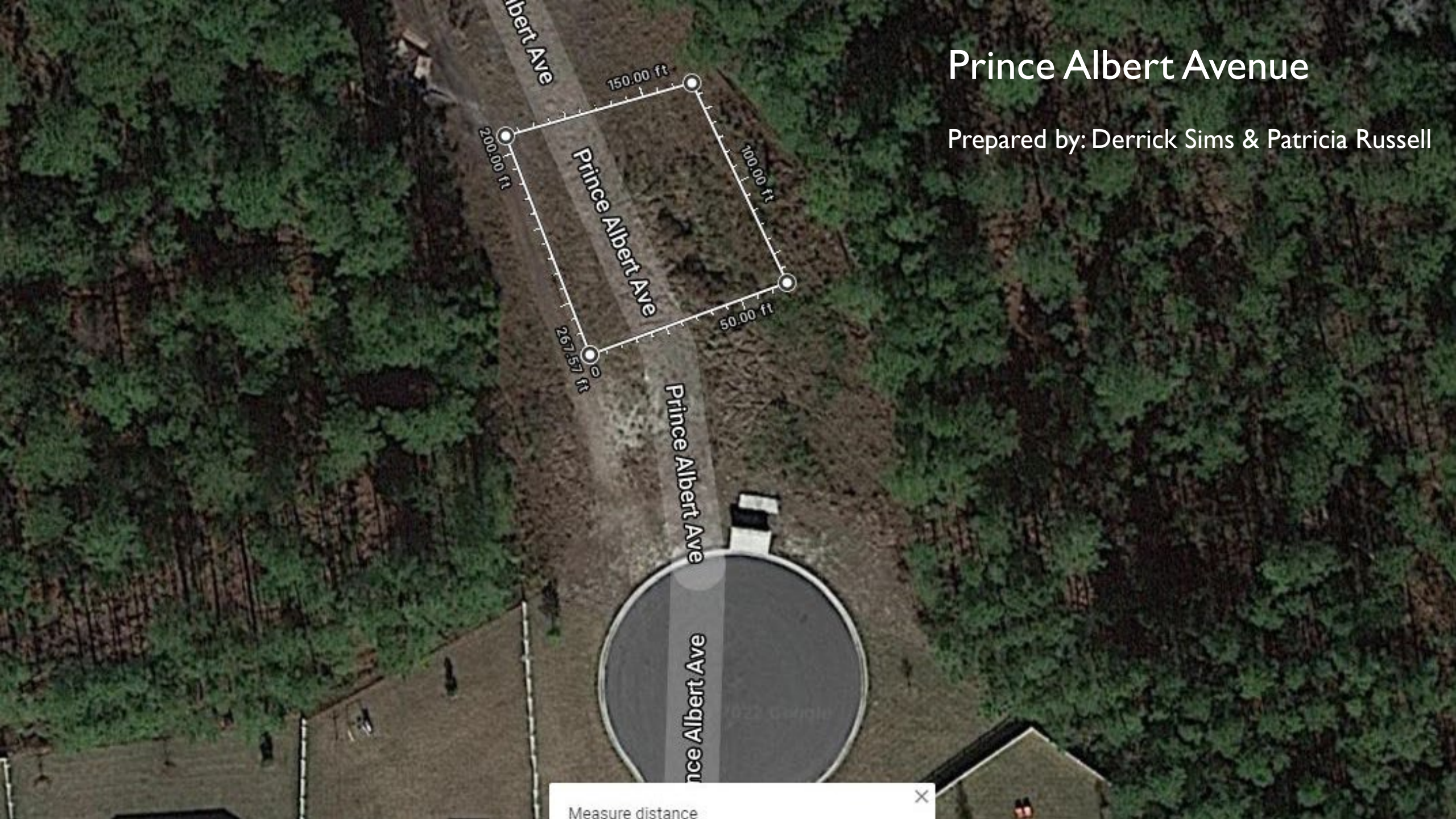

Measure distance



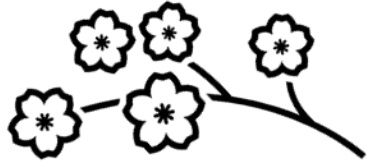

Executive Summary

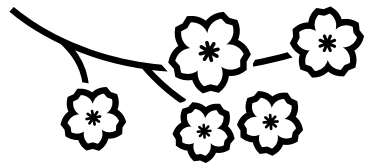

❖ Objective

- The residents of Grandholm Estates would like a neighborhood park built on the unused piece of land at the dead end of Prince Albert Ave of everyone to enjoy.

❖ Purpose

- Our residents have put together the following proposal for consideration by the CDD in hope we can proceed in creating a suitable playground for the children of Aberdeen to enjoy. Just with Castle Trail, RusselWood , Wilmot and Prince Albert alone, we have over 50 children of school age (ages 2-12) that would directly benefit from a children's park.



Estimated Playground Cost



Prepared by: Derrick Sims & Patricia Russell

We would propose something like the play set that is listed (R3-20182) as it would fit the space well being that the area is approx. 125ft by 75ft. We would further request some seating in the form of benches to be located within the playground

Description	Unit Price	Quantity	Cost
R3-20182	\$17,367	1	\$17,367
Fence (Black Aluminum 4ft)	\$10,000	1	\$10,000
Land Improvements	\$30,000	1	\$30,000
Benches	\$5,000	1	\$5,000
Total			\$62,367

Project Proposal

Prepared by: Derrick Sims &
Patricia Russell



Supported by the following residents:

- Meghan Schuh Over
- Kyle and Nichole Kittel
- Enas Mousa Kahok
 - Tashene Ramirez
- The Clauser
 - Aicia and Jesse Rauchwarger
- Michael and Mary Jo Schuh
- Derrick Sims and Nicola Armstrong
- Nick and Chantel Charais
- Kasey and Kenneth Ott
- Sheron Anderson Milne
 - The Lecates
- Ashot and Christena Nalbandyan
 - The Gwozdz's
- James and Tanya Hathaway
- The Johnson's

Resident Input

- “After listening to the last CDD meeting. I would like to offer my opinion towards the green space utilization on Prince Albert. The community is in need of more actives that not only the younger community but also the older community can partake in. With the size of that lot, I would love to see a tennis court or pickle ball court. That is the only lot that can facilitate a structure like that with parking. I know homeowners would like another park but if we are honest with the community the parks are not used as much as people would think. I believe a tennis court or pickle ball court would be utilized by a larger portion. Also when you look at the location of the lot it would not be disturbing any residents with the lights or added noise. At the moment the closest public court is in the Mandarin Park. As a resident I think we should have a variety of activities for the residents to partake in.”

-Lauren Taylor

Aberdeen CDD – Fort William Drive



Measure distance

Click on the map to add to your path

Aberdeen CDD – Sterling Bridge (existing)



Aberdeen CDD – Braewick

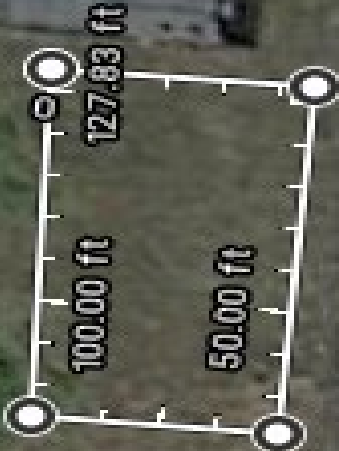

Measure distance
Click on the map to add to your path

X

Scotch Pebble Dr

Scotch Pebble Dr

JQ Dr

Aberdeen CDD – Sutherland Forest





Aberdeen CDD – River Dee

168

164

VENDORS

- Boogle Conviviality Booster - [Who are we? - BOOGLE® - La pétanque Booster de convivialité](#)
- Beezland - [Amusement Park Nets – Fiber to Net](#)
- Lil Guppy Playground Pump - [Lil Guppy Playground Pump - Cadron Creek Play](#)
- R&R Outdoors - [About Us | R&R Outdoors, Inc. Outdoor Pool Tables - All Weather Billiards \(randroutdoorfun.com\)](#)
- Beyond Your Ordinary Recreation - [BYO Playground | Commercial Recreation & Playground Equipment](#)
- Shade Creations - [Waterloo Tent | Carnival & Shade Solutions](#)
- Taylor & Associates Inc. - [Outdoor Commercial Furniture | Colorado | Taylor & Associates, Inc \(taylorincorporated.com\)](#)
- 9 Square in the Air - [9 Square in the Air](#)
- Southern Recreation - [Jacksonville Florida Playground and Park Equipment and Installation \(southernrecreation.com\)](#)
- Sport Surfaces - [Sport Surface resurfacing and construction in florida | Sport surfaces](#)
- Project Innovations Inc. - [Contact Us – Project Innovations Inc. \(myusaprojects.com\)](#)
- Gametime - [Playground Equipment | GameTime](#)
- Land Structures - [Commercial Playground Equipment - School Playgrounds - Park Playgrounds \(playlsi.com\)](#)
- Playground Boss - [Products - Playgrounds - SALE - Playground Boss](#)



Boogle Conviviality Booster *The Color Model*

- BOOGLE COLOR is a top of the line product, combining the lightness of aluminum and the innovation of BOOGLE in petanque lane that will look exactly how you want it to look.
- The BOOGLE COLOR uses the RAL complete color chart with more than 1,600 shades. Impossible not to find the one that will match your enterprise's corporate identity, or even your favorite color.
- You will also be able to choose your finish (shiny, semi-shiny, matte, or even metallic or structured) that will put the final touch to your customization.
- Measurements: 8 M x 2M
- Weight: 100 kg
- Volume: 60cm high x 220 cm long x 45 cm wide.

Boogle Conviviality Booster *The Corten Model*

- The very best of our BOOGLE playing grounds with its Corten steel borders. Corten or weathering steel is a steel alloy which were developed to eliminate the need for painting and form a stable rust-like appearance after several years exposure to weather. It is used for its appearance and its resistance to atmospheric conditions, in architecture, landscaping, construction and art, mainly sculptures for outdoors.
 - The borders of the Corten playing ground are folded, welded and finished in a professional sheet-metal works to produce exceptional effects. Even more than a conviviality booster, it is a luxury product which can become a permanent playing ground.
 - Our BOOGLE CORTEN playing ground can be put up in less than 10 minutes.
-
- Measurements: 8 M x 2M
 - Weight: 234.70 kg
 - Volume: 60cm high x 220 cm long x 45 cm wide.

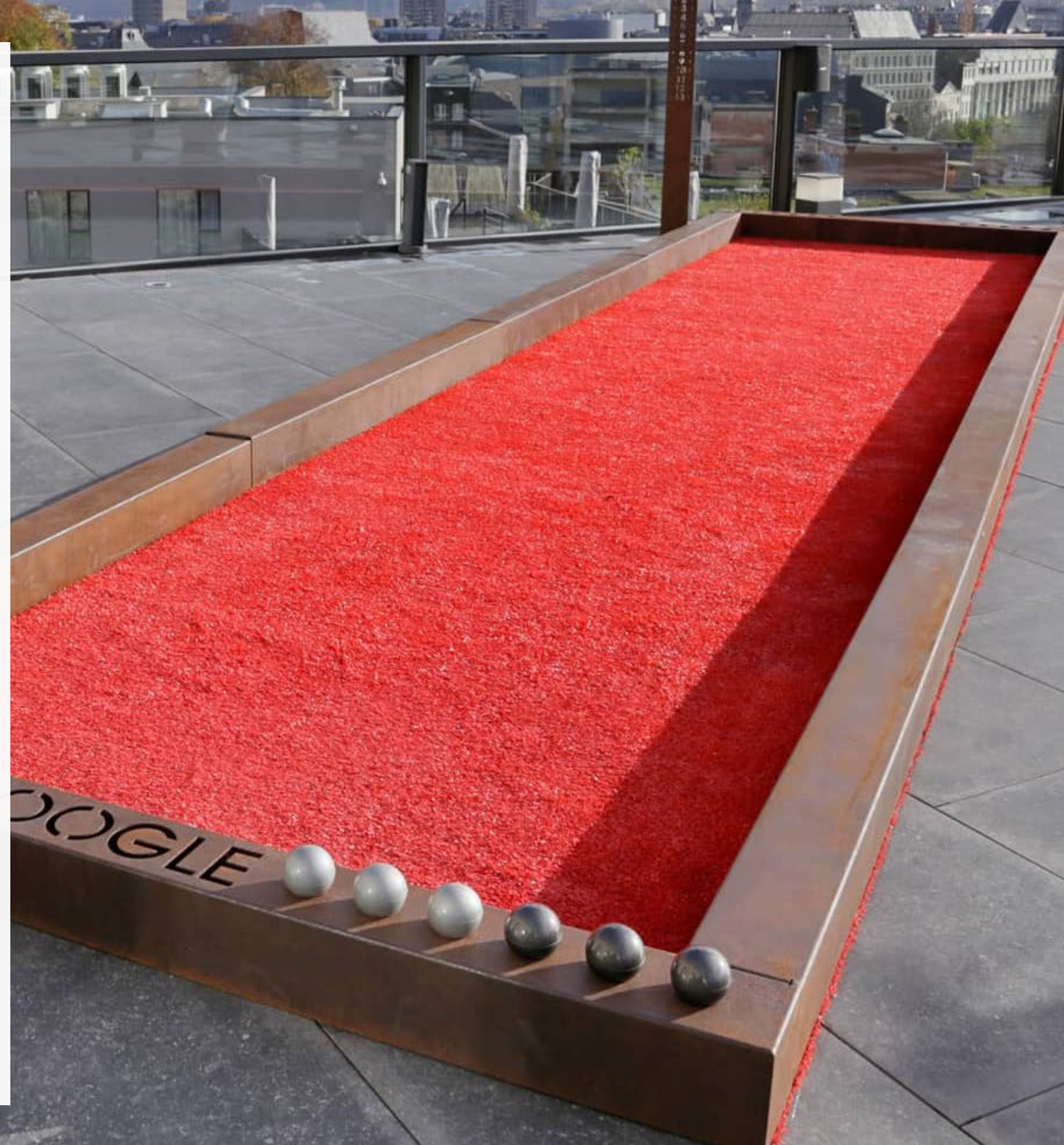



BEEZLAND CROCHET KIDS PLAYING GROUND

- Our netting products are designed specifically for certain kinds of uses. A system that is used in an amusement park would have different requirements than one used in a construction environment. Rope netting products which are used in the amusement industry must meet the ASTM requirements for safety.
- Fun facts
 - ▶ 28' wide x 20' long
 - ▶ 14 hand-dyed colors
 - ▶ 5 hanging pendulums
 - ▶ 40 miles of braided nylon
 - ▶ 8 entry holes
 - ▶ waterproof



Lil Guppy Playground Pump

- Water play helps develop motor skills and problem-solving skills. When using the Playground Pump, kids also benefit from social-emotional growth as they work together to pump the water. It encourages language development as children learn new vocabulary related to water science. Finally, Playground Pumps are a great STEM teaching tool. From simple mathematical concepts (full, half, empty) to more complex concepts like pounds of force required to lift x amount of water, the Playground Pump is a fun way to stimulate inquisitive minds.

Pump Information

- ✓ 22 3/8 inches tall from base to top of the handle
- ✓ Made of stainless steel
- ✓ 11 3/4 inch long spout
- ✓ Designed for heavy-duty kid traffic



R&R Outdoors

Life is better played outside!

- We are the original and only manufacturer of regulation, outdoor pool tables using the preferred 1-inch Brazilian Slate Bed. We also manufacture other fun outdoor games.
- They can withstand wind, rain, salt water and snow.
- Our pool and game tables are built for both residential and commercial play, indoors and out.
- Each table is individually constructed to the size, style, color, and customizations that you choose.
- Activities
 - Cornhole
 - Foosball
 - Shuffleboard
 - Table Tennis
 - Pool Table (11 different styles)



Beyond Your Ordinary Recreation

- BYO Playground began in 1999 with a backyard swing set and an idea – to be the best in commercial playground equipment services. Our idea has grown from that simple backyard swing set to large commercial playgrounds that have inspired creativity and imagination in children all over the world.

Shade Creations *By Waterloo*

- We specialize in custom canvases and covers for amusement parks, carnivals, aquatic centers, parks, and more. They cover your rides, games, pools, playground equipment, and other areas.
- This clear-span designed structure is the perfect solution for your large primary shade needs such as concessions seating and playgrounds.





Taylor & Associates Inc

OUTDOOR FURNITURE

- Practicality, simplicity, and elegance are at the heart of the Taylor & Associates outdoor furniture product line.
- Commercial Outdoor Furniture for Hotel Pools, Water Parks, Theme Parks, Apartment Communities, Municipal Parks and Beaches Nationwide.
- They carry Benches and Picnic Tables.
- They carry Grills in several sizes and different configurations.

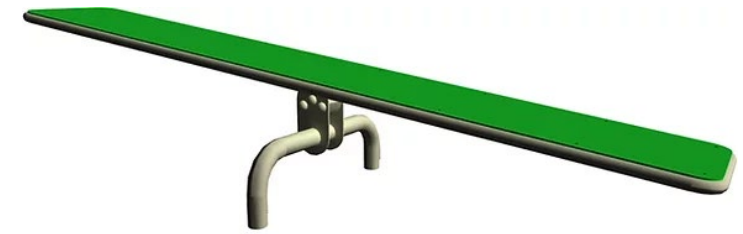
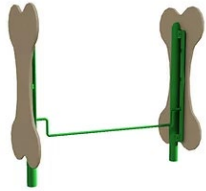

Taylor & Associates Inc

Dog Park

- We provide fun for your dogs!



9 Square in the Air

- We have heard from thousands of customers that this game is perfect for all ages and skill levels and has been an incredible tool to build community in their neighborhood. It pulls people together, gets them laughing, smiling and moving.

Southern Recreation Florida's Top Choice for Parks and Playgrounds

CANOPY SHORES CITY PARK

- The local Parks Department was looking for a unique “treehouse” designed playground.



Southern Recreation

PALENCIA PARK

- The counties Park & Rec department was seeking bids on a “pirate” themed playground.





Southern Recreation

ALTOS DEL MAR PARK

- The City of Miami Beach approached us with the challenge of creating a totally unique, one-of-a-kind playground for one of their beachside parks.



Sport Surface

- Sport Surfaces offer a variety of different courts and games.
 - Cornhole Court
 - Pickleball Court
 - Horseshoe Pit
 - Giant Chess
 - Bocee Ball Court
 - Beach Tennis
 - Sand Volleyball Court





Project Innovations Inc

*Play For A Day & Learn
For A Lifetime*

- Our well-designed playgrounds not only will enrich the lives of local children, it acts as an important hub for the community – attracting families, boosting the popularity of suburbs, and creating a focal point for activities. It makes a park into a destination, giving it energy and personality. Our playgrounds are those places.

- **ADA** Compliant



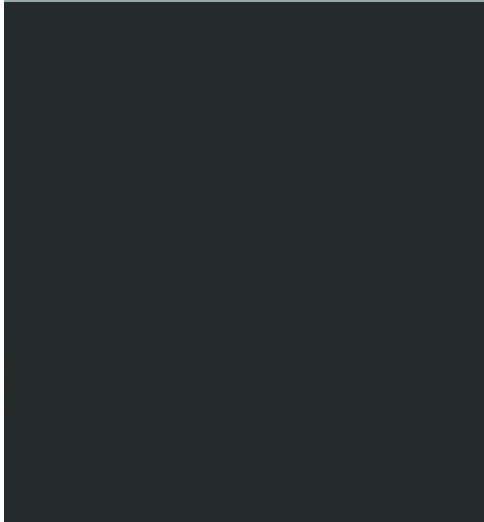

Age Range: 2-12 years
Child Capacity: 28-32
ADA Compliant

The most exciting feature of this play structure is, of course, the trio of 5-foot slides that children can ride down after climbing up to the hill's summit via the Sea Creature Climber or accessible Transfer Station.

The wave Slide in the middle follows a straight path but has a bumpy shape that slows kids down and adds to the fun.

The Left and Right Turn Slides on either side of it are longer and have an optional colorful striped pattern.

For children who want a slightly gentler ride, there is also a 3-foot Double Slide.

The fun continues at the bottom of the slides, where kids will find a Store Panel that is a perfect setting for them to play out imaginary games and scenarios with friends.

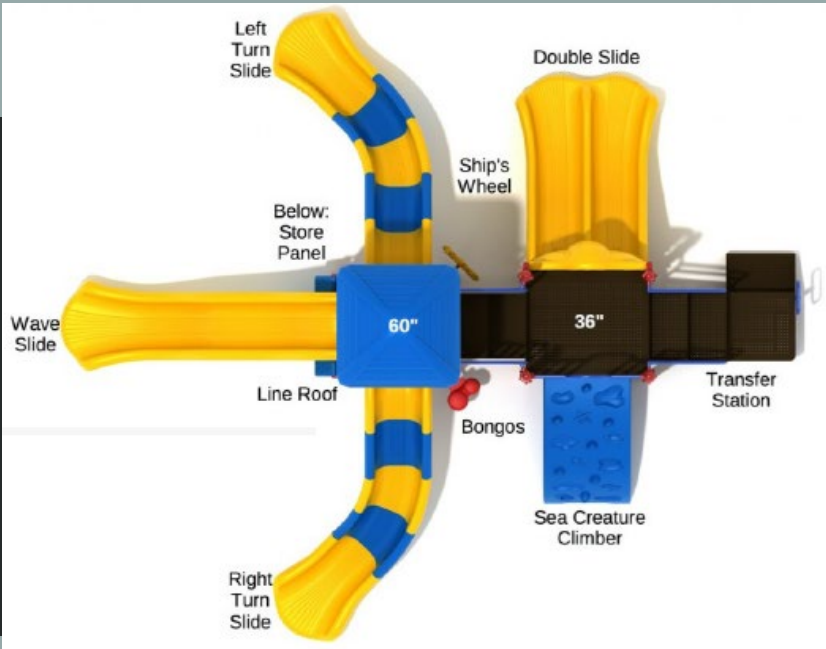
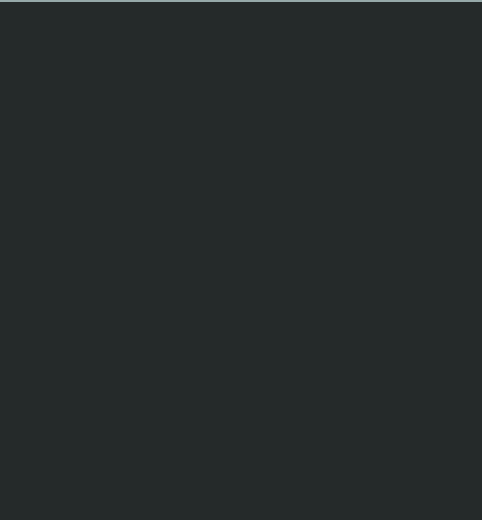

Age Range: 2-12 years
Child Capacity: 28-32
ADA Compliant

- Perhaps its most exciting feature is its three slides. It has a pair of large Turn Slides connected to a 60-inch deck, as well as a smaller 3-foot turn slide for a more gentle ride.
- Flanking the two large slides are a pair of vertical climbers: a Vertical PE Rock Climbing Wall, and a Spiral Climber.
- These provide interesting and unique climbing experiences, as well as a quick way to go right back up to the top of the slide after riding it down. This way, children are given a choice of what climbing and sliding experience they prefer, allowing them to choose their favorite or try all of them.

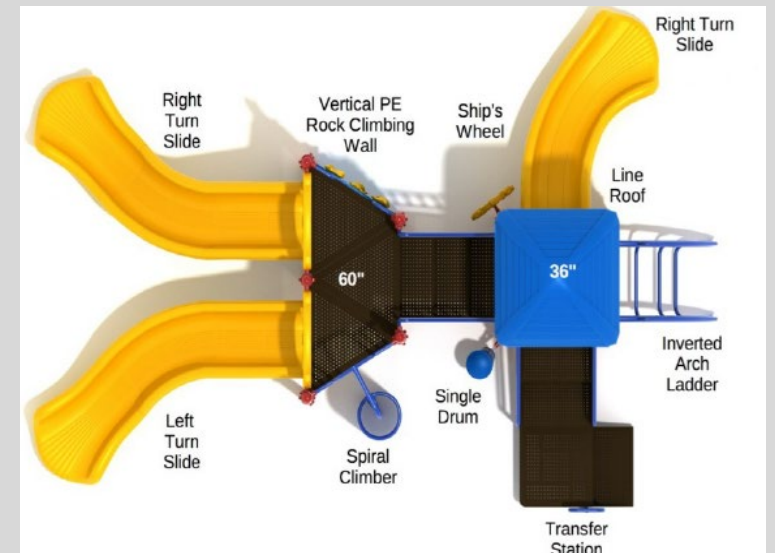



GameTime Menlo Park, CA





GAMETIME
TOUCAN HIDEAWAY

Landscape Structures

Domino Park





LANDSCAPE STRUCTURES

CENTRAL PARK OF MAPLE GROVE



LANDSCAPE
STRUCTURES
PACO
SANCHEZ
PARK

PLAYGROUND BOSS





Neighborhood Volunteers



- We are looking for about 2-3 , if not more, volunteers from each neighborhood to participate in this project!